

Splashbacks & Wall Panels in High Gloss, Satin Finish, any colour & Filler EFX™

Bonethane®, available in any colour & EFX. A Polymer based product & coating formula, crafted & customised modelling strength, flexibility & colour spectrums that are simply endless. Bonethane® Premium has a continuous service temperature of 110°C, Bonethane® GN Acrylic grade has a continuous service temperature of 85°C. Light flexible, bringing style to any home or commercial environment. See our new filler EFX™ endless designs mixing colour combinations, used as either a mosaic filler design creating length extension, bordering or as a splashback or feature wall. Custom designed with your specific mix of colour blend, coordinating colours in high gloss or satin finish. Our Premium Metallic Satin finish range is durable & great for table tops, perfect for kitchen tables & bench spaces. Be in control, choose your colour, choose BonethanePremium or BonethaneGN Acrylic all custom made!

Bonethane® available in two grades Premium 120°C High Heat Polymer suitable for induction cook tops(maintain distance specifications, showers cubicles, wet areas, feature walls, hospitals, bars, does not split or crack when following cutting instructions. **GN Acrylic grade 100°C great for feature walls & shower cubicles, not suitable for any cook-top.**

FEATURE & BENIFITS

- ▶ Bonethane® grades are DIY & cost effective. Premium Sheets do not split or crack when cutting.
- ▶ Bonethane® grades can be cut down with ease on site including power points & innovative angles.
- ▶ Bonethane® grades available in any colour, metallic & **Abstract** EFX™. Can be colour matched up to 12% variation to your selected colour choice.
- ▶ Bonethane® is suitable for indoors, outdoors & most wet areas. Applied virtually anywhere you can imagine. Great for shower cubicles!
- ▶ Bonethane® grades installation is easy, fast with a visual reward in a matter of hours.
- ▶ Bonethane®GN Acrylic grade requires more attention when cutting & should not be confused with Bonethane Premium both substrates cut differently & handle heat differently.
- ▶ Easy to clean, warm soapy water & sponge, rinse residue. Bonethane® grades air dry & shine, no polishing necessary saving you cleaning time. Harsh cleaning agents, gone!
- ▶ Bonethane® grades can be placed over existing surfaces.
- ▶ Bonethane® grades come with Grip Tech backing, no need to coat walls a neutral colour or sanding of the backs of sheets.
- ▶ Bonethane® Premium is DIY friendly will not split or crack when cutting with standard fabricating equipment. Strictly follow our step by step instructions.
- ▶ Bonethane Premium has better heat distribution than Acrylic grades of material. Burn test on You Tube Bonethane Premium Vs Acrylic & out Candle burn test.
- ▶ Scratches easily buff out, see us demonstrate on Youtube
- ▶ Bonethane grades are a custom made to order DIY product. Order what you need in any colour, accessories also available. We can create your corporate colour & logos into our sheeting.
- ▶ On Bonethane Premium ISPS can double your Warranty, ask how.

[View Bonethane Premium VS Acrylic on You tube](#)

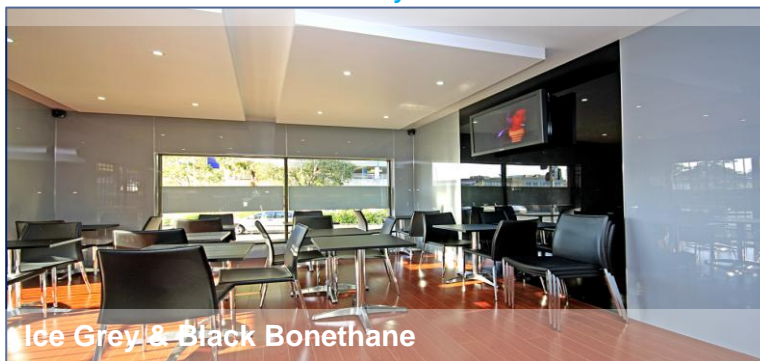

Ice Grey & Black Bonethane



Bonethane Premium

Violette



Mushroom

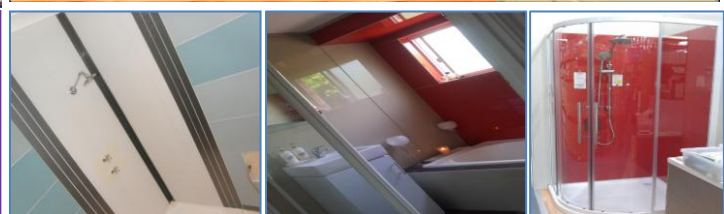

Get Creative

Midnight Metallic Star

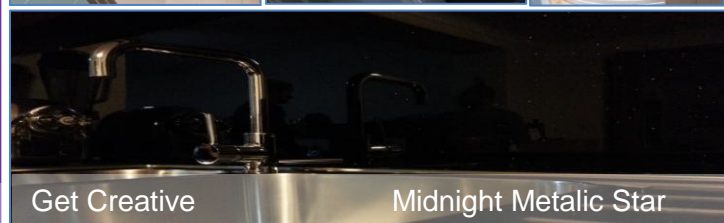

Step by Step Installation Guide

Step 1

Lay Bonethane® flat for first 3 hours prior to Installation. Ensure wall is level flush free from holes neutral in colour forming even flat surface for Bonethane™ placement. Use only led pencil for marking cut outs or cuts on back of sheet, coated side.



Step 2

Measure the outside perimeter of the wall. Length and height, allowing 1 to 2ml gap all around. For example if you: measure 500 height by 500 length your cut out area should be 498 x 498 (2ml) It is important that the 1 to 2ml gap is followed, allowing Bonethane™ to expand and contract. Also measure section for cut out.



Turn off Electricity from main switch!!!

Step 3:

On perimeter of Bonethane® allow a 1 to 2ml gap all around. The tile wedge will be placed around the perimeter of the mm gap once clear silicone is applied to back & placed upright, against wall. The tile wedge will hold Bonethane™ in place (more about this in STEP 8)



Step 4

It is important to place Bonethane® face down (masked side down) in preparation for cutting. The area for the preparation of cutting must be free of obstacles, on a solid flat, non slip surface, in a well ventilated, lit area. Ensure the Bonethane® sheet is firmly secure in preparation for cutting.

Step 5

Power hole cut outs vary on the power switch. The cut out should not be greater than the covering plate. An electrician will also need to connect electricity if you have extra outlets.

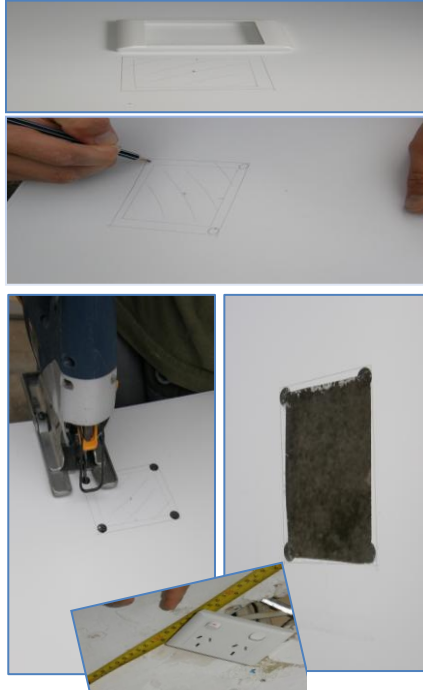

Step 6

Cut splash back once perimeter and cut out(s) measurements are final, making sure, Bonethane™ is face down, (that is the masked side is touching the flat level non slip surface and the coated side is facing you.



Step 7

After clear silicone grid process, mount Bonethane® onto wall, inserting cables through power hole cut outs, securing tile wedges around the 1 & 2ml allocated perimeter, leave tile wedges for approximately 2 hours. Clean surrounding areas free from saw dust particles. Once secure, peel off protective film from Bonethane® face. Please refer to "Care Do's" for keeping Bonethane® bright & beautiful



TIPS: Incorporate tiles as a design

DO NOT BUTT UP AGAINST COOK TOPS

Bonethane Premium suitable for induction cook tops

Step 8

Switch off Electricity for your safety!!! Add clear silicone to the coated side of Bonethane® (this is the side that does not have protective film), first vertically from the top then horizontally creating a grid of squares around 10 to 15 cm width and length ways.



Step 9

Finally use silicone clear non acidic to seal 2ml exposed joints & seal. Clear is always the safest choice, white is effective if you have a steady hand or you may seek the services of a professional. Follow instructions for silicone application, the product you choose should display instructions, make sure it is a water proof silicone used for kitchen and bathroom areas. When Bonethane® is upright & in a secure position peel off masking.



ISPS Innovations can provide a fire rated insert, custom made for behind your gas cook top. Made from Vetro Poly Star fire Toughened Glass in either metallic Silver or colour toned to blend with Bonethane® Premium or Bonethane®GN. Please enquire about our glass offer call **08 8381 8880**.



ISPS also customise trim in 6mm Anodised or Colour coded to finish your joints & Filler EFX.

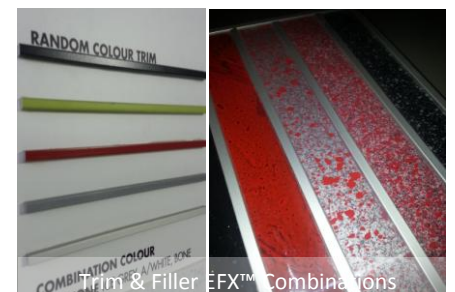

Do not butt up against cook top

What you need Not included in Pack Jig saw fine sharp teeth to cut Premium & fine sharp plastic teeth blade for GN Acrylic grade. Drilling requires plastic drill bit attachment. The following items also required, tile wedges, silicone non acidic (Parfix All Purpose clear Silicone), protective goggles, dust mask, saws, spirit level. Call ISPS if in doubt 7 days a week.

Some of our standard Colour Range

Orange 5101984



Lime 5101983



Mushroom 5101985



Satin Blue 5101986



Grape 5102174

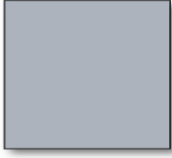
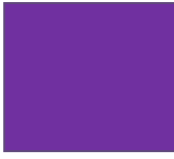

Ice Grey 51019878



Apple 5101979



A/White 5101982



Bone 5101981



Black 5102174



Satin Blue

BonethanePremium available in 16 standard Colours. The colours on this brochure vary from the actual colour. View display board in store for accurate colour. Call ISPS if you are unsure of colour



A/White



Apple Bonethane Premium



Induction Cook-top



Retro Dusk Bonethane Premium & Silver VetroPoly™ Toughened Glass



Grape



Ice Grey



Chocolate



Kaboodle Green



Flinders Green



Linseed



Splashbacks & Wall Panels in High Gloss, Satin Finish, any colour & EFX



Bonethane® Premium Doors & Splashbacks

SPECIAL ORDER

For custom colour selection simply follow these steps:

1. Choose any colour sample either from our standard colour range, paint colour chips or another colour you may have ie (fabric), anything really.
2. Bring your colour chip into store for placing your order. You will need to supply the colour chip for colour matching.
3. Place your order at the Special Orders desk.
4. Your custom coloured Bonethane will be supplied in 10 to 15 work days.

Colour Toning Existing High Gloss Bonethane Grades

If you are extending, & require more Bonethane, ISPS Innovations can colour tone additional Bonethane for your project. What we require is a piece of Bonethane at least A4 to A3 size to be posted back to us, so we can process colour. We can have up to a 12% variation in colour toning gloss colours. If the gloss sample is too small we are limited in our colour process which can blow variation out to 25% & can effect pigment ratio. When colour matching satin colours we are dealing with one range of colour, when colour matching high gloss we need to factor in light contrast along with gloss depth. A small sample in gloss limits full colour range & variation up to 25% can occur. So the bigger the gloss sample the better the match.

TIPS & COLOURS: 1 to 6

- 1) When ordering multiple colours, it is best to order of same colour batch. Ordering off different batches can result in variations.
- 2) A/White on white can appear grey, so choose your white carefully, this may be a special order.
- 3) Bonethane Grades come with Grip tech backing, no need to coat walls a neutral colour or sanding of the backs of sheets.
- 4) Adhesive, clear neutral cure silicone apply in grid format 10cm apart.
- 5) Use standard jig saw with fine sharp teeth for cutting.
- 6) Use plastic cutting blade for GN grade acrylic grade & plan cuts. Please call ISPS for tips & helpful information
- 7) Bonethane Premium is DIY friendly & will not split or crack when cutting & drilling with a jigsaw with fine sharp teeth.
- 8) When ordering from different colour batch through ISPS, please ensure an A3 or A4 gloss sample is provided.

Please refer to our colour section on our website for more information on colour process www.ispsinnovations.com.au

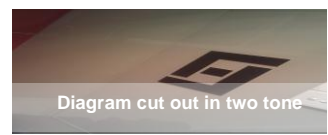

Note M2 rate applies to straight cut only. Additional charges apply for angles, elevated & power hole cut outs.

5mm	Bonethane® Grade	Size	Item Number
TINY	B/Premium™	400 X 1200MM	TBA
MINI	B/Premium™	400 x2400MM	TBA
SML	B/Premium™	1200 x 760MM	5102178
MED	B/Premium™	2440 x 600MM	TBA
STD (PACK INCLUSIONS)	B/Premium™	2440 x 760MM PACK	5102174
LGE	B/Premium™	2440 x1220MM	5102179
XL	B/Premium™	3000 x 760MM	TBA
XXL	B/Premium™	3000 x 900MM	TBA
XXXL	B/Premium™	3000 x 1100MM	TBA
CUT TO SIZE M2 RATE	B/Premium™	OVER 1.85M2	TBA
CUT TO SIZE M2 RATE	B/Premium™	UNDER 1.85M2	TBA
SMLGN	GN Acrylic™	2440 X 600MM	TBA
STD GN	GN Acrylic™	3000 X 600MM	TBA
LGE GN	GN Acrylic™	2440 X 1220MM	TBA
Shower Pack	GN Acrylic™	2 X 1M X2M SHEETS	5102398
CUT TO SIZE M2 RATE GN	GN Acrylic™		TBA
CUT TO SIZE M2 RATE GN	GN Acrylic™		TBA
Colour Match Flat (solid colour not metallic)			983003
Abstract EFX™			5102346
Metallic			5102345
Printed Logo & colour backing			TBA
Designer cut out & two tone Colour			TBA
Anodised Trim	TRIM	2400MM 6MMSOLID	TBA
Colour coded Trim	TRIM	2400MM 6MM SOLID	TBA
Cut to size 1 straight cut	OPTION		TBA
Cut to shape	OPTION		TBA
Power hole cut out	OPTION		TBA

Bonethane® Premium & GN™ Sheets come with GripTech™ backing. The backing is a different colour to face of the sheet, if you require similar colour backing please advise the team member & ask that they place on your purchase order.

ISPS Innovations always have the right customised accessory for you to finish your project.

Universal Joining Strip for vertical or Horizontal Joins & Designer Filler EFX™ by ISPS Innovations

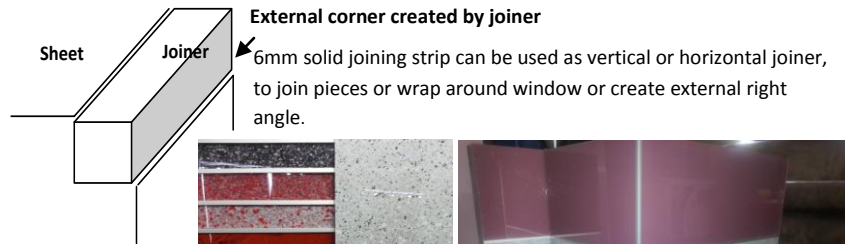
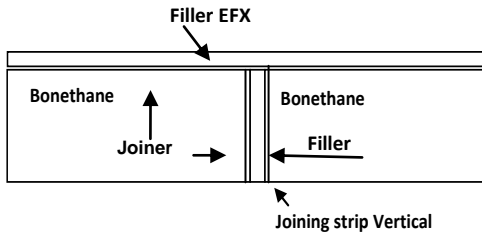

Filler EFX, custom designed. 65mm x 760mm. Longer lengths available. Additional charges apply.

Call 08 8381 8880 for more info.

NEW Bonethane®, Filler EFX™

A design based on the colour furnishings where Bonethane® is applied. Allowing the design to be placed horizontal or vertical within the sheet, housed with our anodised joiners. A stone or marble filler Efx™ creating the finishing touch based on your colour scheme. Bonethane® filler Efx™ fillers can also be used in conjunction with other products. Combination colours designed to your decor.

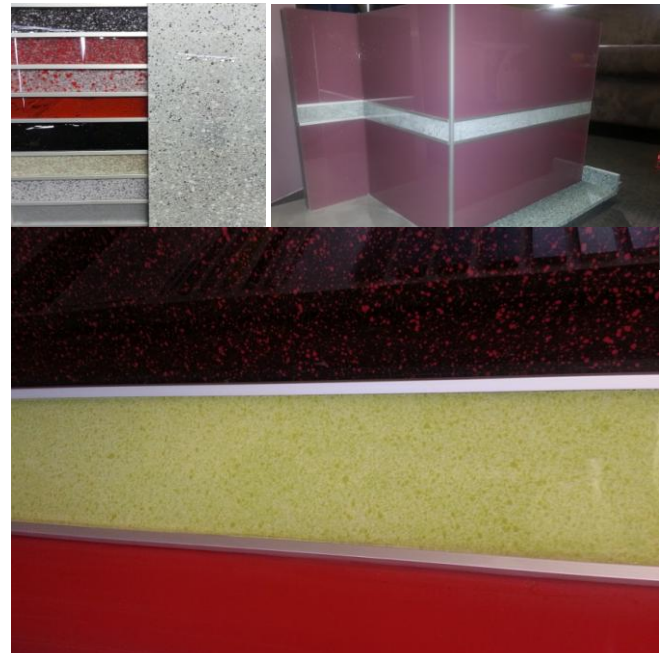

Customised Vetropoly™ Toughened Glass for behind your gas burner



Let ISPS assist you with your cook top needs. If you have a gas burner then Vetropoly™ Toughened Glass is just for you. ISPS can customise glass dimensions to reside specifically behind your cook top in metallic silver or colour toned to Bonethane sheeting.

STD Bonethane Premium PACK offer & Upgrades.....

Through Bunnings on item number 5102174 enclosed in this pack are the following items

- ❖ 1 Sheet Bonethane® Premium 2440 x 760 x 5mm
- ❖ 1 Flat colour match on any flat colour (additional charge on metallic)
- ❖ 3 straight cuts (all the way through the sheet, angled cuts additional charge)
- ❖ 1 fire rated insert in Silver in either 600 x 300 or 900 x 300 (additional charge on colour toning or customising insert)
- ❖ 6 Anodised Trim @ 760mm
- ❖ 1 Custom Filler EFX™ 65mm x 760mm

If you purchase two of these fine line numbers (5102174) to complete your project, ISPS will upgrade your insert for behind your cook-top from either a 600 x 600mm or 900 x 600mm in metallic silver. It is important to nominate size of insert as ISPS will place what ever insert is available at the time if this is not nominated. Additional charges apply to change & ship once order is received.

With the Purchase of two sheets (2 x item number 5102174 please see below you get)

- ❖ 2 Sheets Bonethane Premium 2440 x 760 x 5mm
- ❖ 1 Flat colour match on any flat colour on Bonethane® Premium (additional charge on metallic)
- ❖ 6 straight cuts (all the way through the sheet)
- ❖ 1 fire rated insert in Silver in either 600 x 600 or 900 x 600 (additional charge on colour toning or customising insert to Bonethane Sheeting)
- ❖ 12 Anodised Trim @ 760mm
- ❖ 2 Custom Filler EFX™ 65mm x 760mm

Item number 5102179 Bonethane Premium 2440 x 1220 sheet is available in 16 House colours. There are no inclusions, however colour matching, fire rated inserts, trim, filler EFX or cut to size & shape can be purchased at an additional charge.

Splashback – Blank, straight cut NAME: _____ CONTACT PHONE: _____

EMAIL ADDRESS _____ Purchase order number _____

Diagram

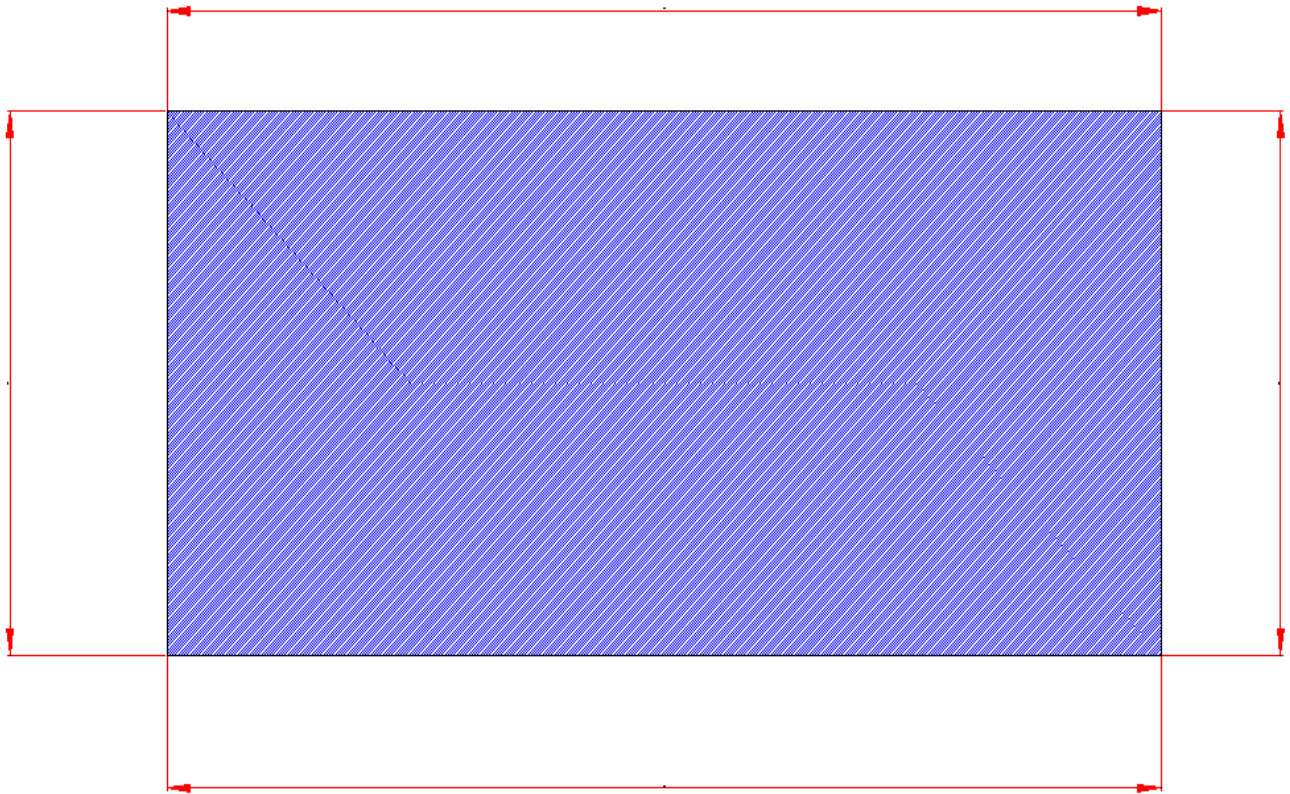
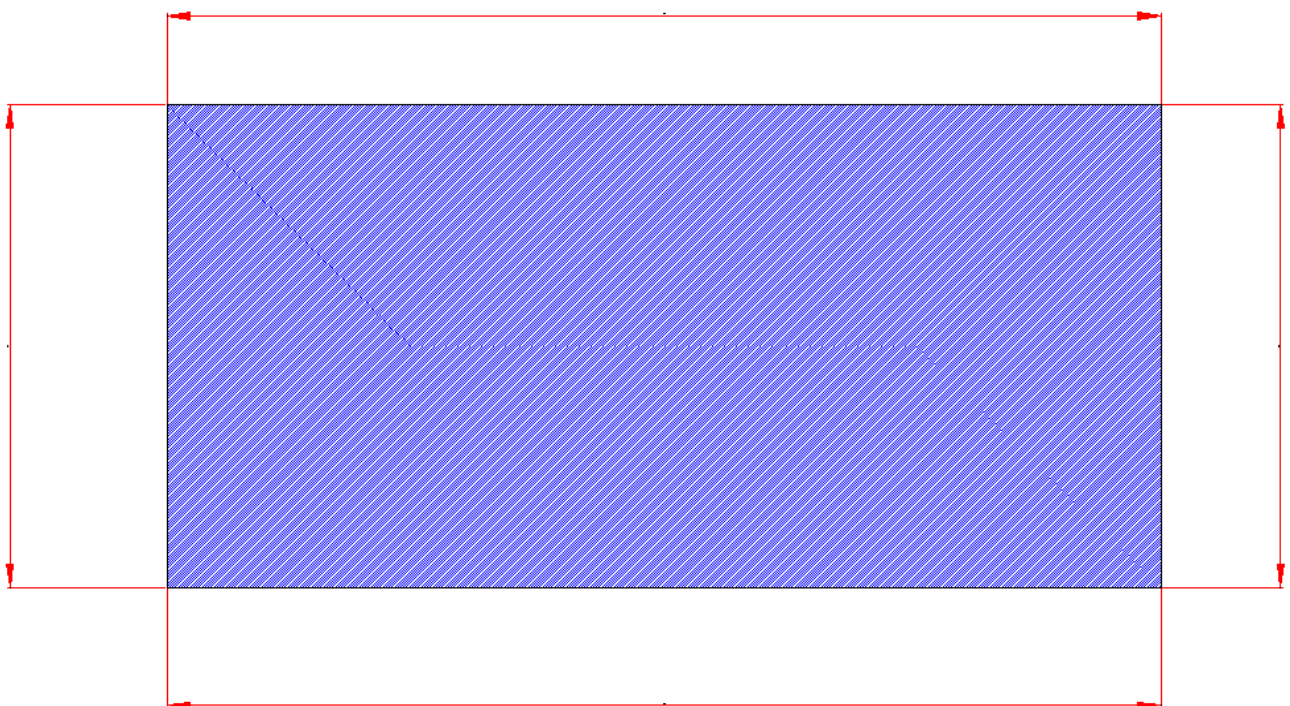

Diagram:



Splashback - Central Cut Out and PowerPoints NAME: _____ CONTACT PHONE: _____

EMAIL ADDRESS _____ Purchase order number _____

Diagram

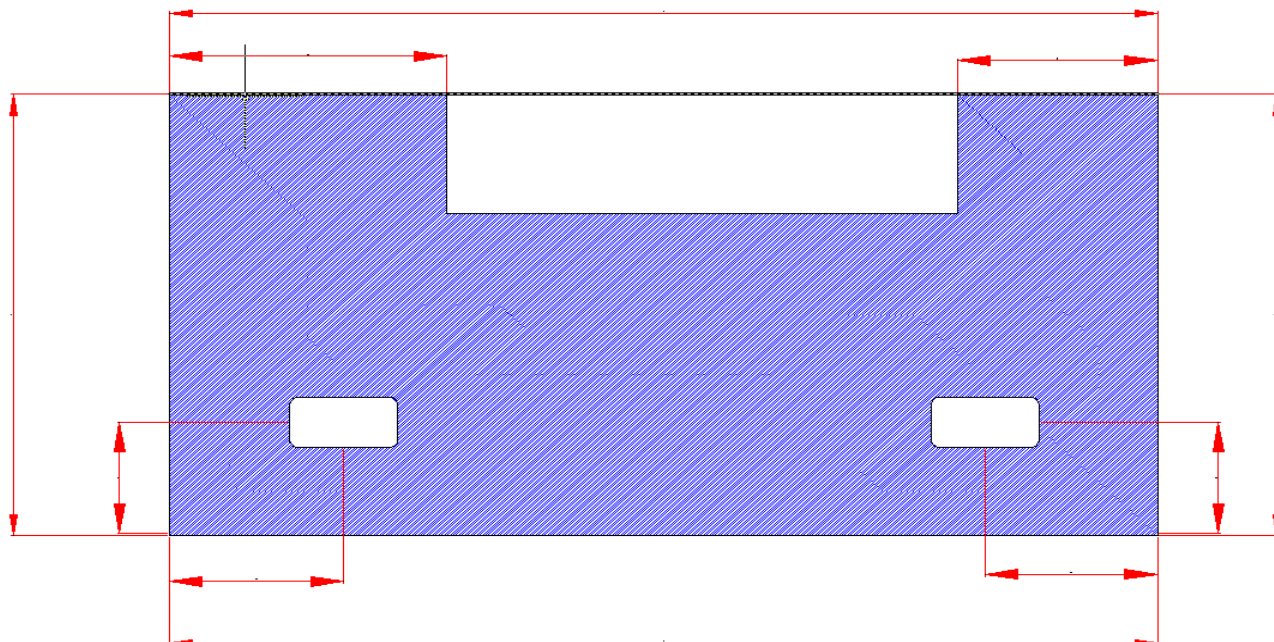

Diagram

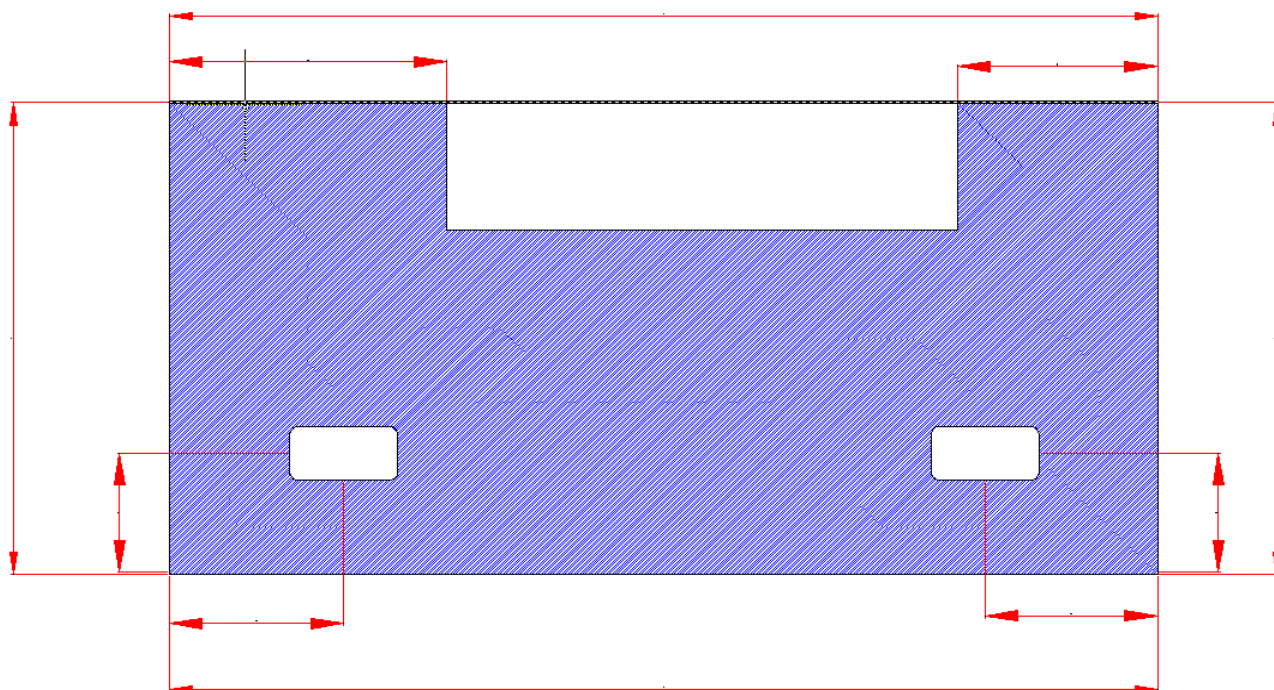

Splashback - Central Rangehood - 2 PowerPoints NAME: _____ CONTACT PHONE: _____

EMAIL ADDRESS _____ Purchase order number _____

Diagram

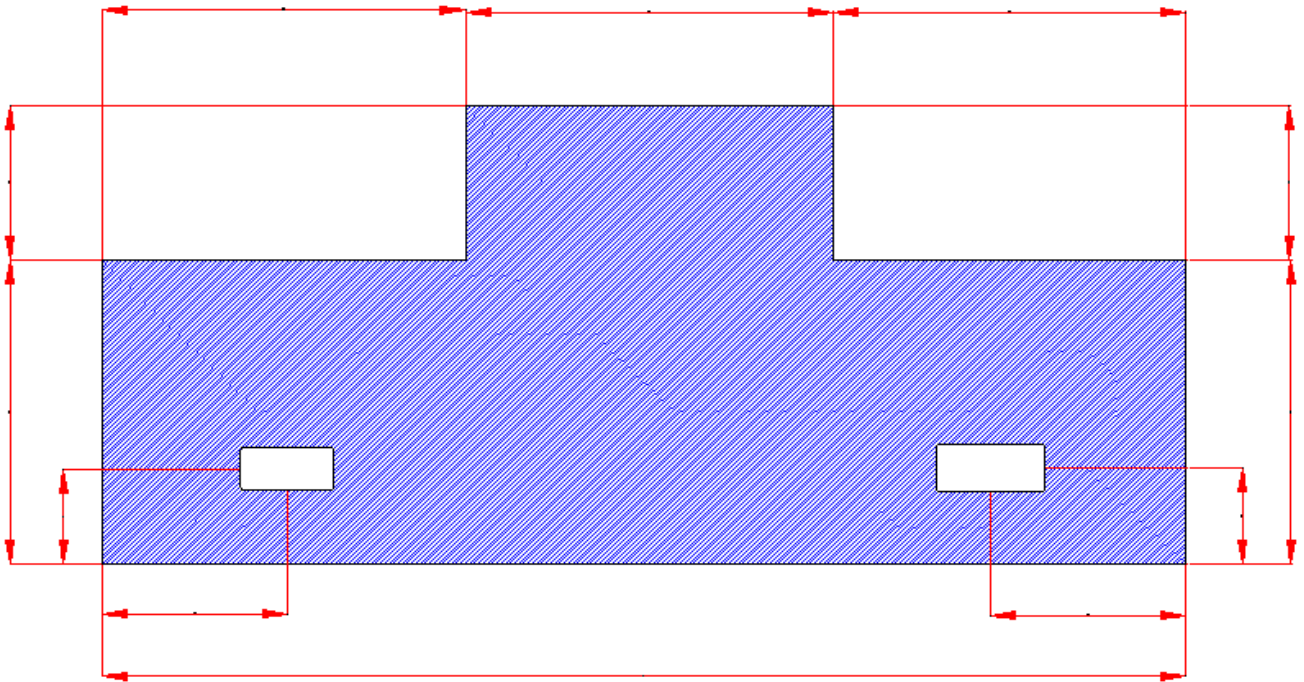

Diagram

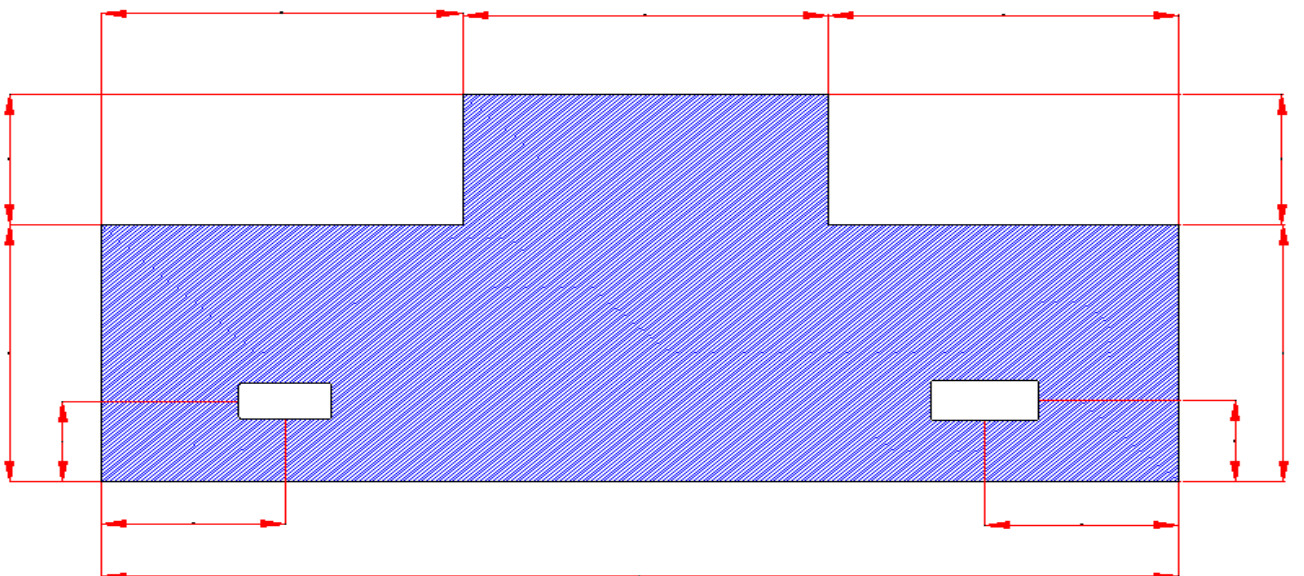

Splashback - Central Rangehood - Left Hand PowerPoin NAME: _____ CONTACT PHONE _____

EMAIL ADDRESS _____ Purchase order number _____

Diagram

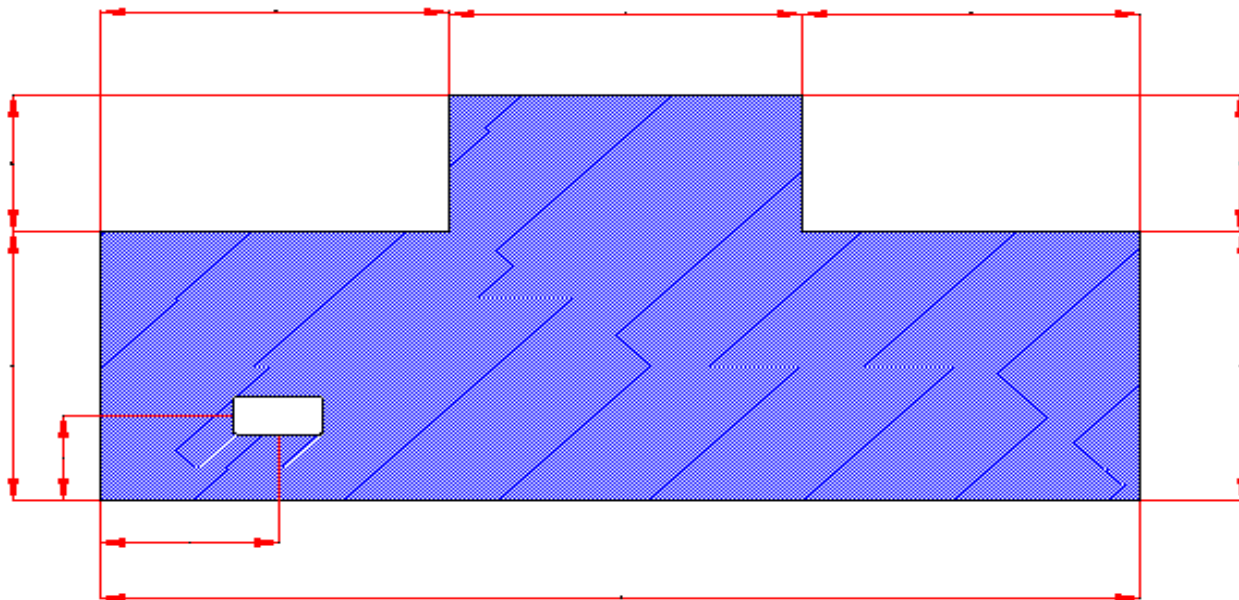

Diagram

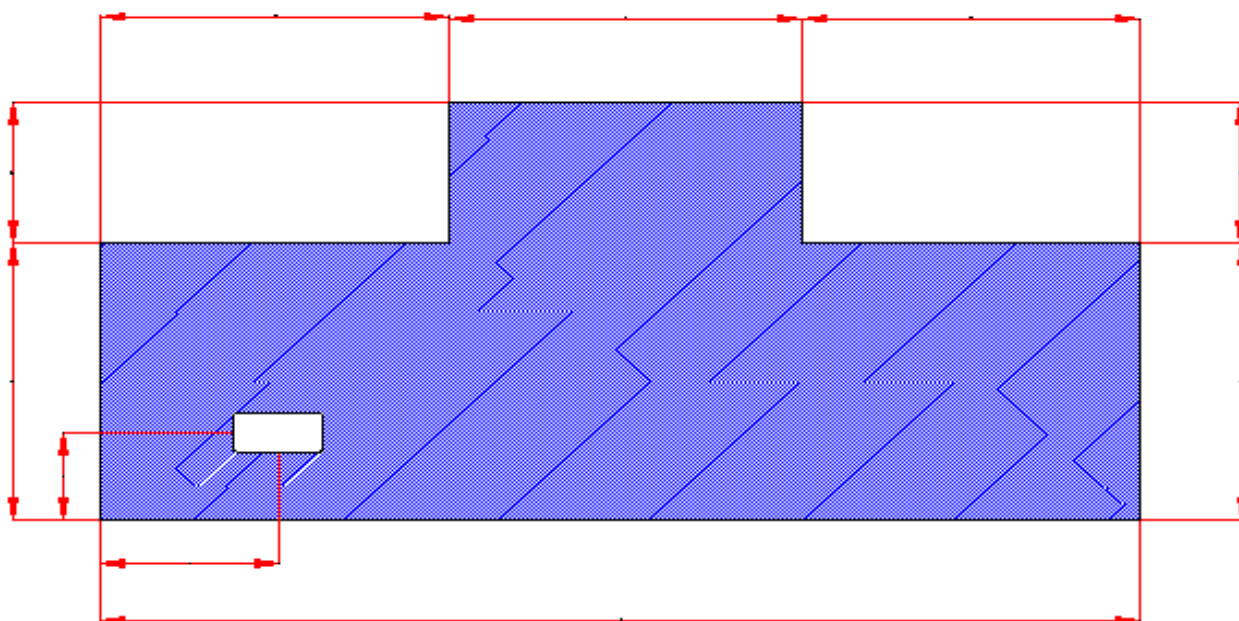

Splashback - Central Rangehood - Right Hand PowerPoint NAME: _____ CONTACT PHONE _____

PHONE: _____ EMAIL ADDRESS _____

Diagram

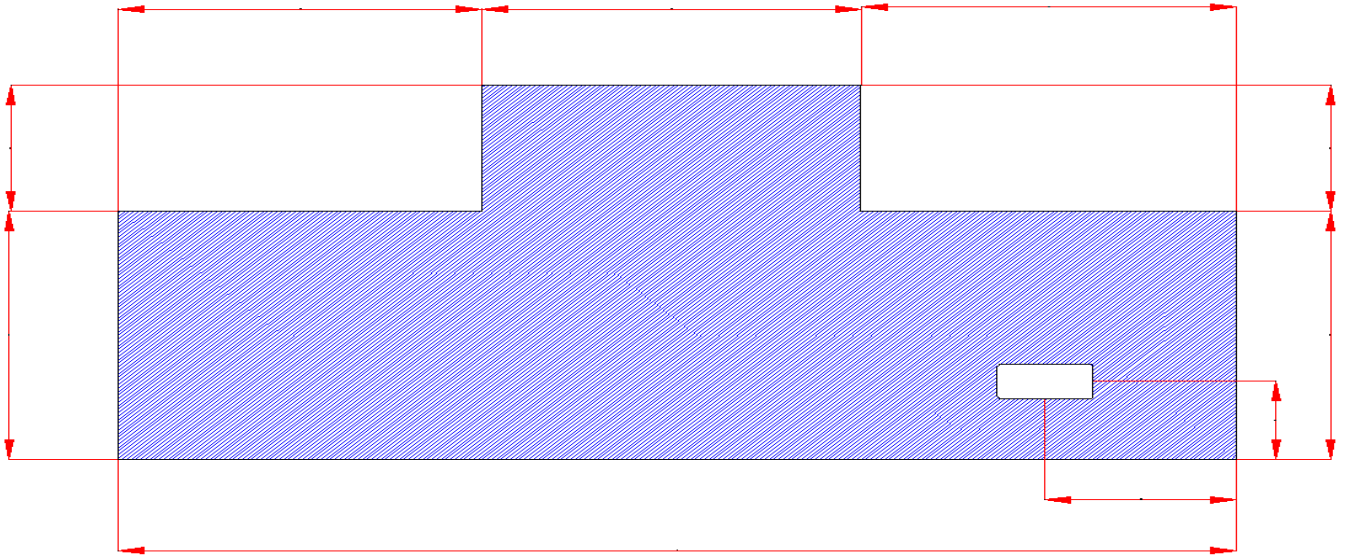

Diagram

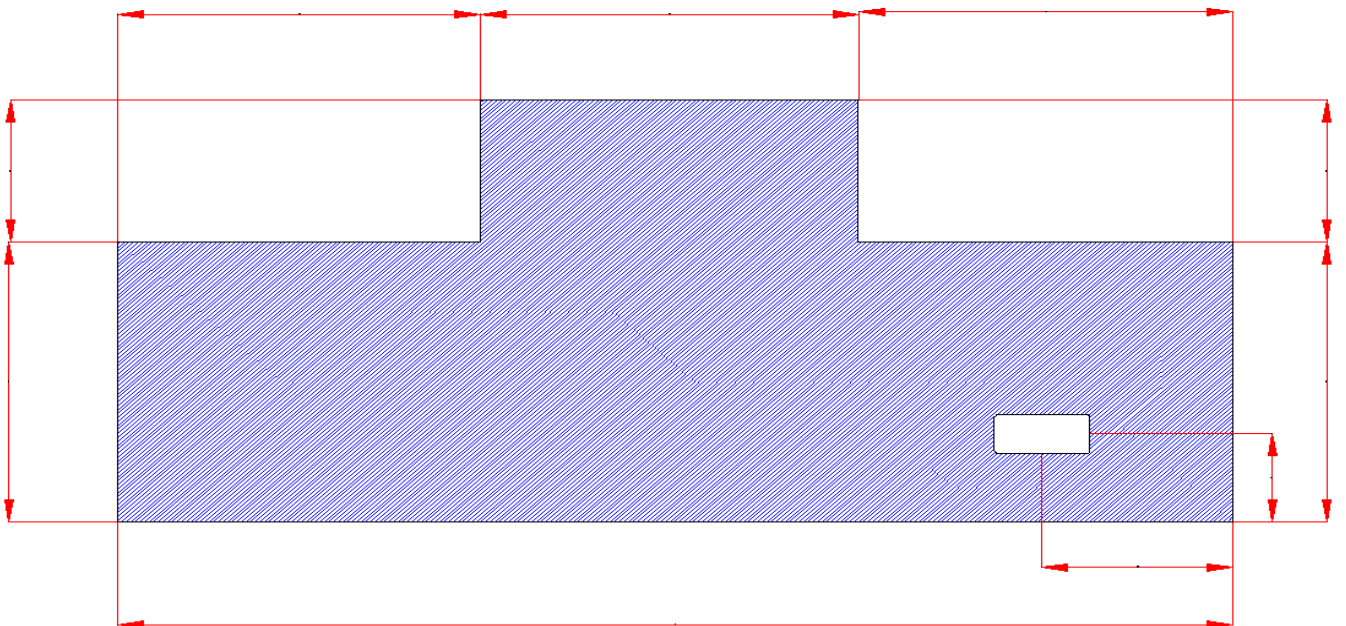

Splashback - Central Rangehood

NAME: _____ CONTACT PHONE _____

PHONE: _____ EMAIL ADDRESS _____

Diagram

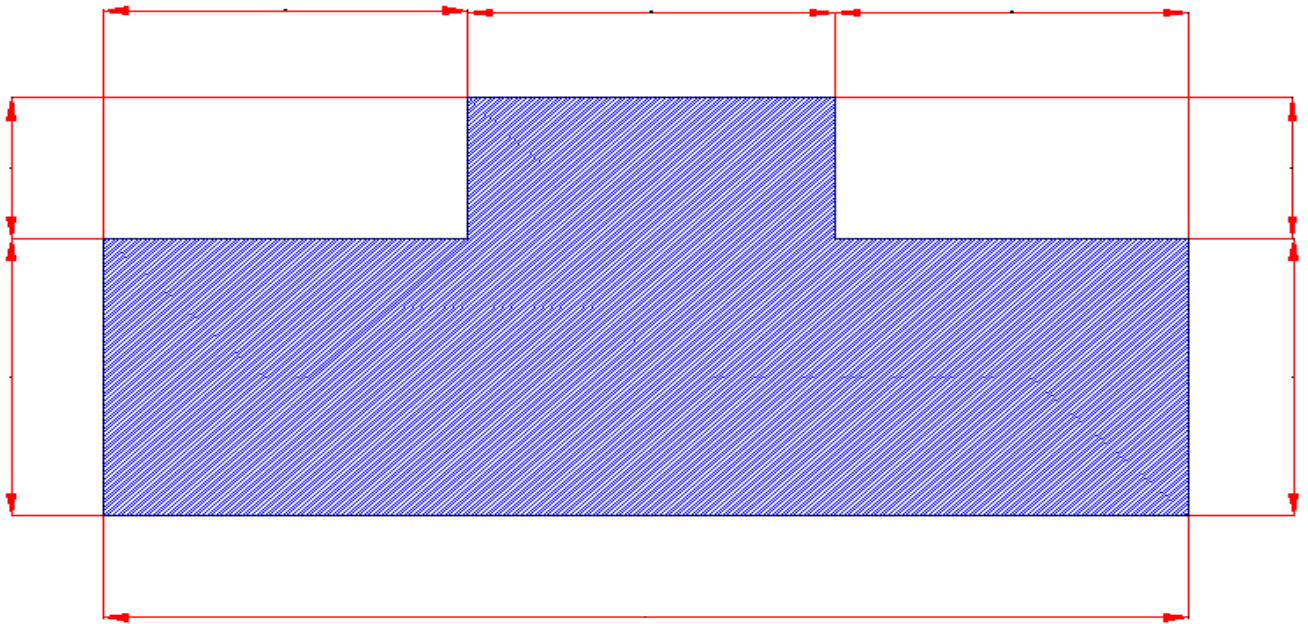

Diagram

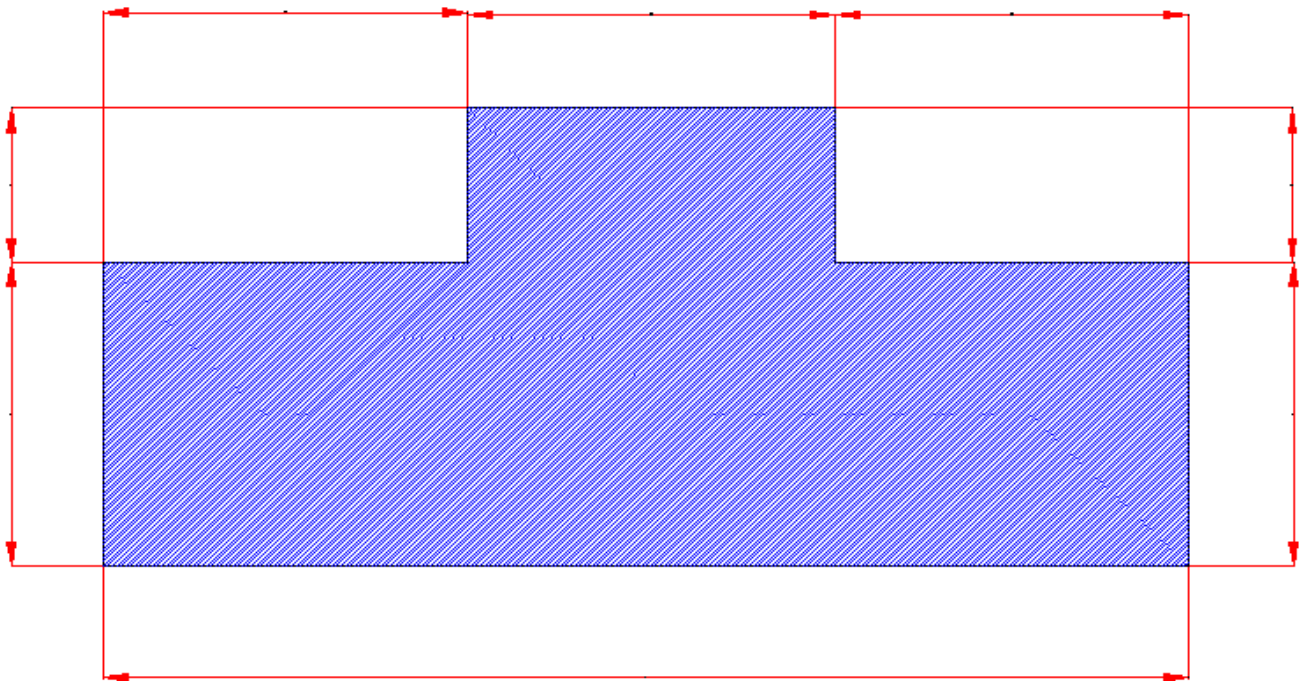

Let ISPS Innovations assist you with all your custom interior & exterior needs. No minimum order quantity.

Stay tuned, more updates to follow.

SPECIALISING IN

- **Benchtops in ColourTek™**
- **Partitions in ColourTek™**
- **Polyurethane Doors in Colour Tek™**
- **BonethanePremium® Splashbacks & Wall Panels**
- **BonethaneGN™ Acrylic grade Splashbacks & Wall Panels**
- **Bonethane10 Flooring, Benchtops, Wall Panels**
- **IPA Acrylic™ Splashbacks & Wall Panels**
- **Vetropoly™ Toughened StarFire Glass**
- **Alumethane™ composite panels**
- **KUTTM8™**

NEW YOU TUBE CLIP ON INSTALL OF BONETHANE PREMIUM LAUNCHED. ALSO SCRATCH TEST ON OUR PREMIUM SHEET. SEE US POLISH PREMIUM GRADE IN REAL TIME BEFORE YOUR EYES! <http://www.youtube.com/watch?v=SwpP8VSA3Yq>

www.ispsinnovations.com.au

BURN TEST Bonethane Premium Vs Acrylic & Candle Test, Bonethane Premium goes head to head with Acrylic substrates <http://www.youtube.com/watch?v=5LbYZRtsvY> (Bonethane Premium Vs Acrylic)

http://www.youtube.com/watch?v=icl9VoH0_Vs

(Line up candle test, Bonethane premium is 5th in the line up (red sample) counting from left to right)

